

Assembly Picture

80311 LAF&RAF PWR/PWR Recliner

Assembly Instructions

Carefully unpack all parts before attempting to assemble.

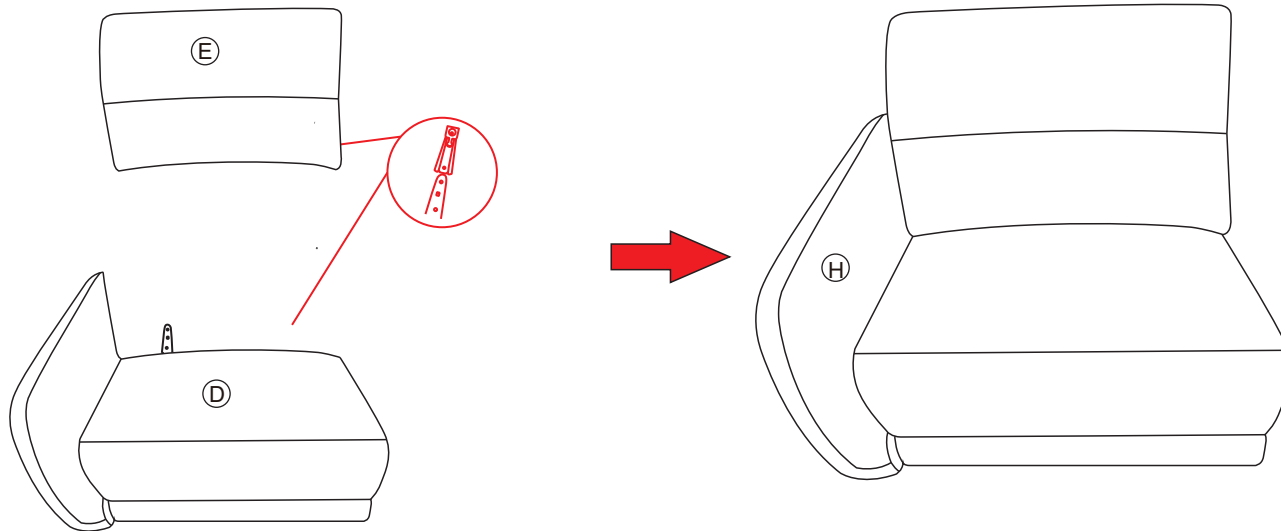

STEP 1. Install the Backrest(E) into the Seat (D) by positioning the female metal receiver brackets over the male metal posts. Ensure that female metal receiver brackets on each side of the backrest are positioned over the seat metal posts. Install the Backrest(G) into the Seat (F) in the same way. Then connect LAF PWR/PWR Recliner to the RAF PWR/PWR Recliner.

STEP 2. Connect the power source.

STEP 3. Buckle up the male and female headrest connections first by tipping on the back, connect the power transformer and plug in to your electrical wall outlet with the AC cord.

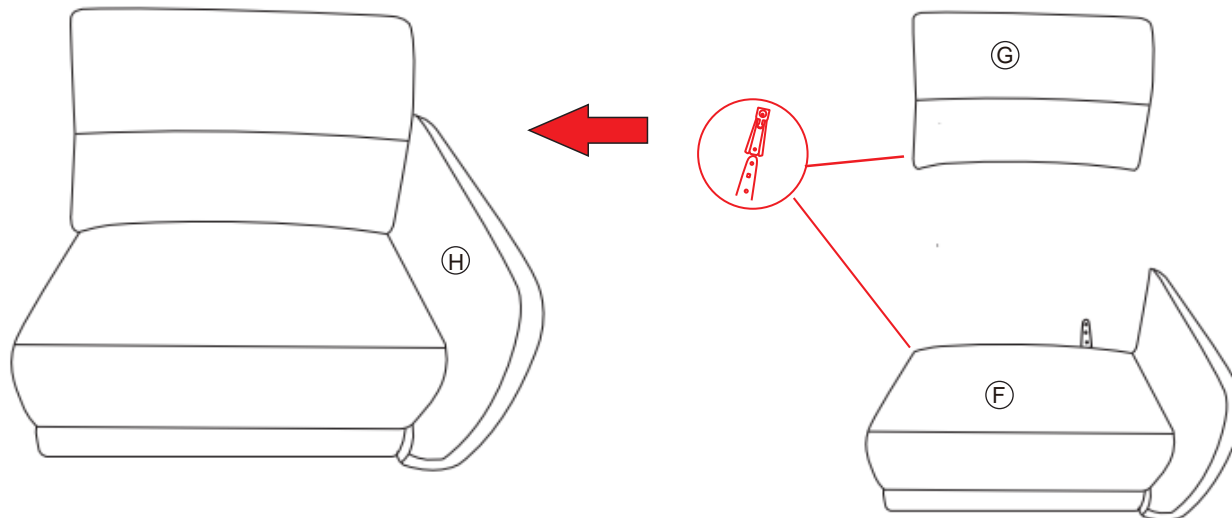

PART LIST

A-Motor wire	2
B-Power Transformer	2
C-Power Cord	2
D-LAF PWR/PWR Recliner Backs Seats	1
E-LAF PWR/PWR Recliner Backs Backs	1
F-RAF PWR/PWR Recliner Backs Seats	1
G-RAF PWR/PWR Recliner Backs Backs	1
H-Power Switch	2

Assembly Picture

80311 LAF&RAF PWR/PWR Recliner

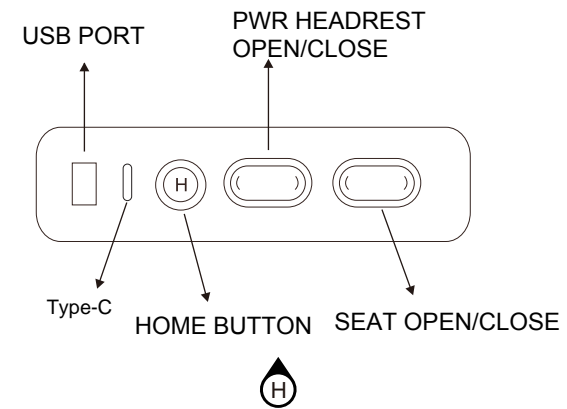
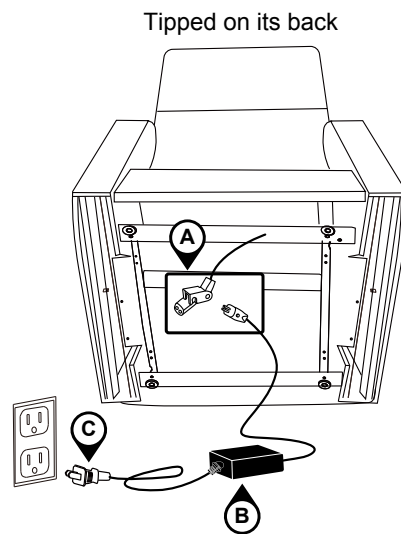
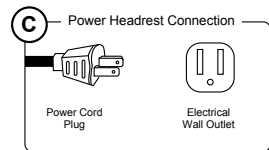
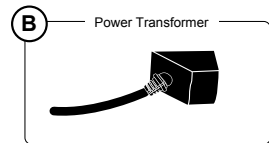
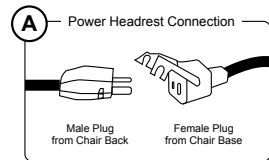
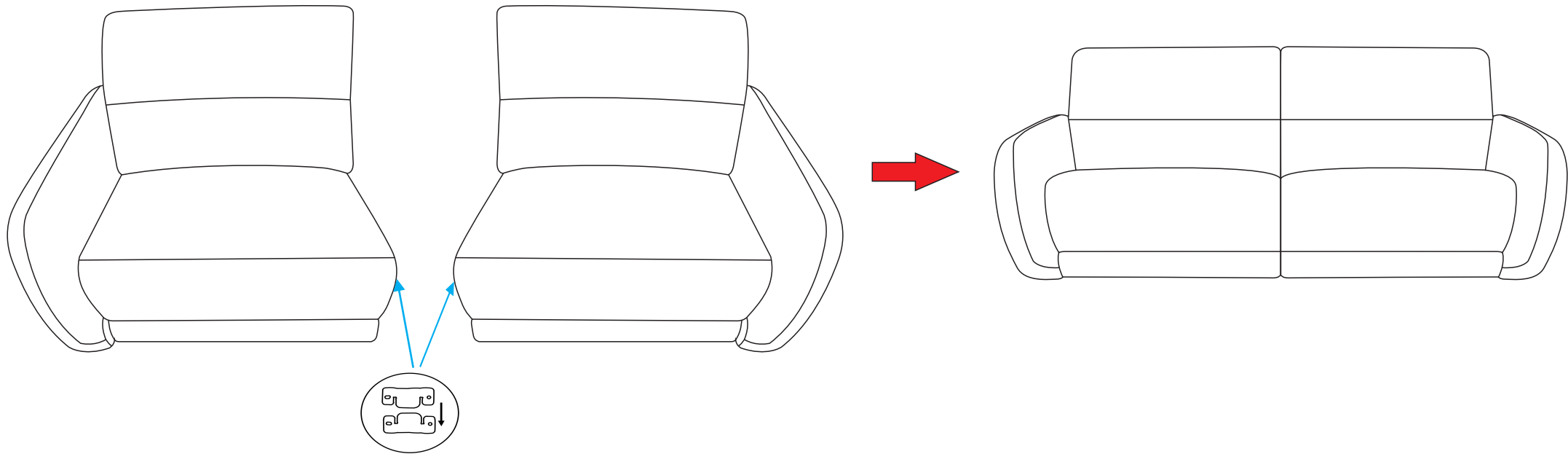

Simple Assembly Instructions—Please keep for future reference

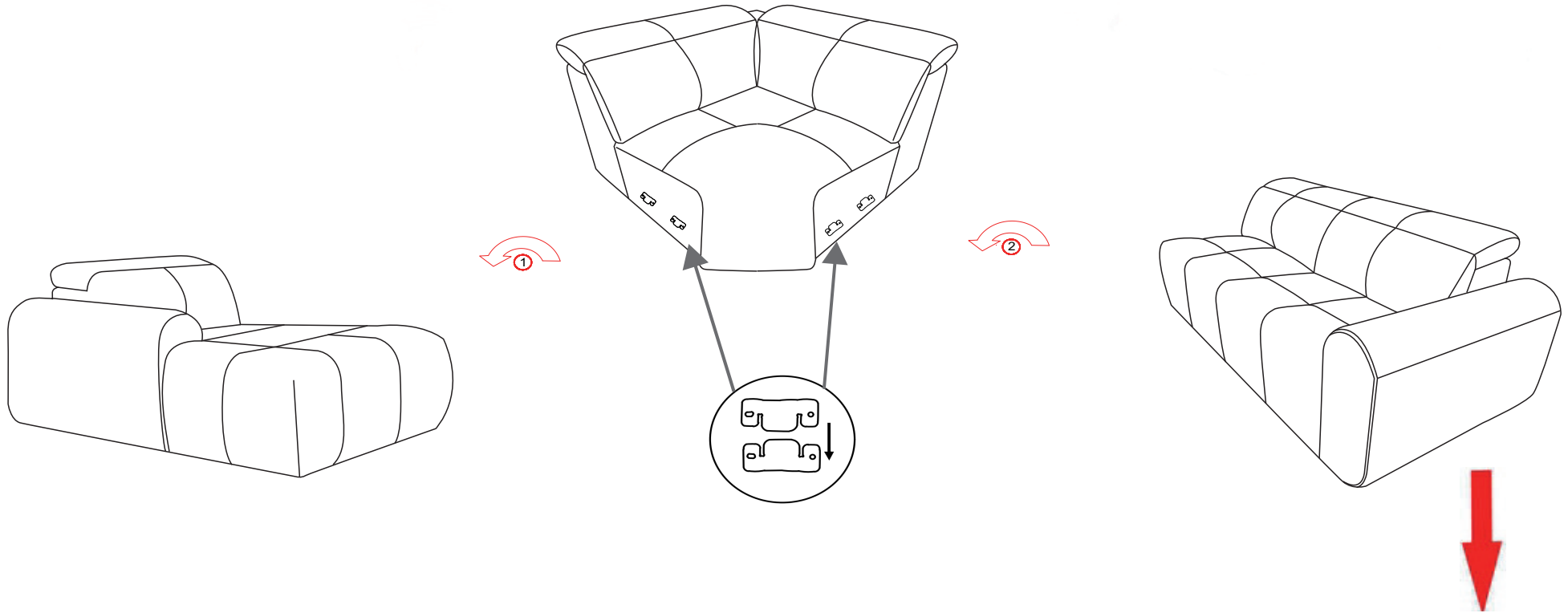

IMPORTANT

1. Read these instructions carefully and familiarise yourself with the procedure before assembling the unit.
2. Check that you have all the component parts and familiarise yourself with each part before proceeding.
3. Take all the fittings out of the plastic bag and separate them into groups.
4. Ensure you have enough space to lay out all the parts before assembly.
5. To avoid scratching it is recommended that you assemble the unit on a soft level surface.



Finished